



Nightingale Walk, Hemel Hempstead, HP2 7QY

Offers In Excess Of £185,000

Situated in this highly sought after cul de sac development in Woodhall Farm is this purpose built top floor flat. Boasting two bedrooms, 15'9 living room, fitted kitchen, double glazing, residents parking, communal gardens and is being sold with the benefit of no upper chain. Located close to the local shops including a Sainsburys, transport links and the M1, M25 and A41 road links.

Communal Hallway

Stairs to all floors

Entrance Hall

Front door and airing cupboard.

Living Room 15'9 x 11'3 (4.80m x 3.43m)



Double glazed window, TV pint and electric heater.

Kitchen 8'0 x 8'0 (2.44m x 2.44m)



Wall and base units with work surfaces to compliment, stainless steel sink with drainer, electric hob with cooker hood over, electric oven, double glazed window, plumbing for washing machine, Tiled splash backs and storage cupboard.

Bedroom One 12'9 x 9'7 (3.89m x 2.92m)



Double glazed window and electric heater.

Bedroom Two 9'1 x 6'10 (2.77m x 2.08m)



Double glazed window and electric heater.

Bathroom



Panelled bath with shower over, low level wc, pedestal wash hand basin, tiled walls and extractor fan.

Communal Gardens

Residents Parking

Floor Plan

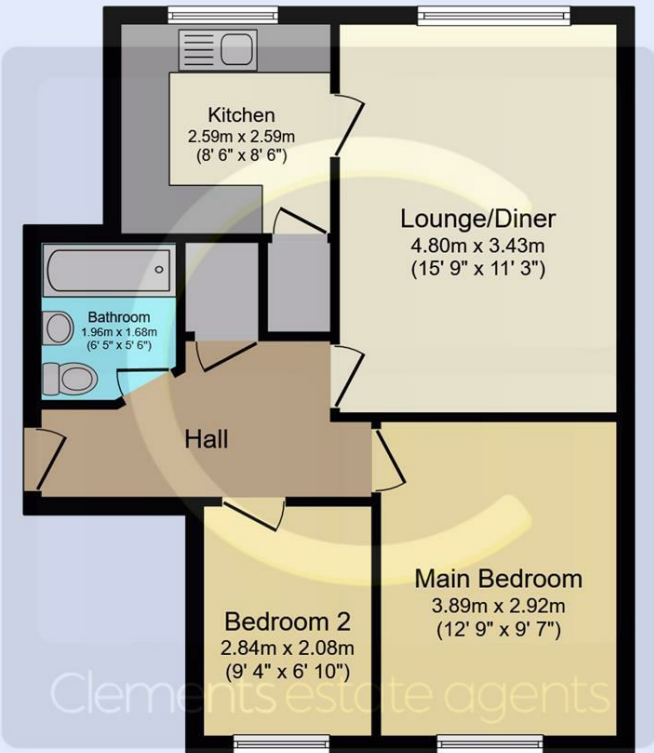

Floor Plan

This floor plan is for illustrative purposes only. It is not drawn to scale. Any measurements, floor areas (including any total floor area), openings and orientations are approximate. No details are guaranteed, they cannot be relied upon for any purpose and do not form any part of any agreement. No liability is taken for any error, omission or misstatement. A party must rely upon its own inspection(s). Powered by www.Propertybox.io



Area Map



Energy Efficiency Graph

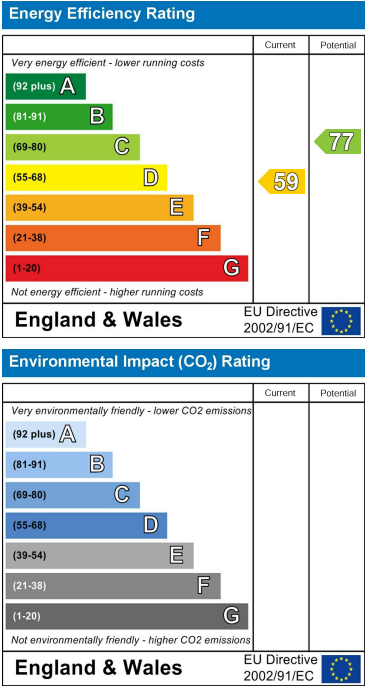

These particulars, whilst believed to be accurate are set out as a general outline only for guidance and do not constitute any part of an offer or contract. Intending purchasers should not rely on them as statements of representation of fact, but must satisfy themselves by inspection or otherwise as to their accuracy. No person in this firm's employment has the authority to make or give any representation or warranty in respect of the property.